



DA VINCI
ARCHITECTURAL HARDWARE



SHAPING A WORLD
OF BEAUTY THROUGH
DA VINCI

Introduction

We are a **DA VINCI ARCHITECTURAL HARDWARE** team of young professionals: Design, Supply and Build your Dreams of exterior and interiors of your loved Building / Projects.

The **DA VINCI ARCHITECTURAL HARDWARE** talented and Innovative team is working on shop design and build.

Our professional team will schedule an in-person appointment with you to take space measurements, offer you design working your professional consultation.

And we always put the best effort and materials to the satisfaction of our clients... We are proud to announce that we have Built Good trust and satisfactory notes from our clientele. Through making a dream in to reality we have put forth our 7 years of continuous Learning and Build Innovations and have smiled with the client with every project we completed. We look Forward to meet you in person and better understand your Requirements and take it forward.





DVH-01

DIAMOND Continue System

Finishes
Wooden | Anodized | PVDF | Powder Coating



Essential Features

Space Saving and Minimalist Design.

Economical with Good Aesthetic Design.

Specialy for Residence, Hotels and Public Area.

It is Ideal for Indoor and Outdoor.

- | This railing is both sturdy and easy to install, so you can create the perfect look with minimal hassle.
- | The best part is that this railing is maintenance-free and will never rust.
- | This profile comes in 16 ft length.
- | Profile is compatible for upto 3 ft height of glass



DVH-01

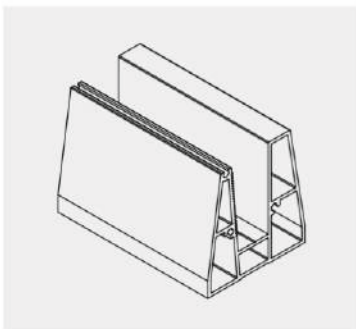

DVH-01 EC

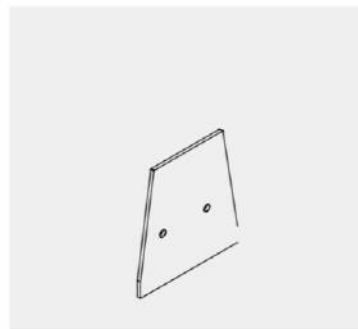

DVH-01 EC SLOTTED

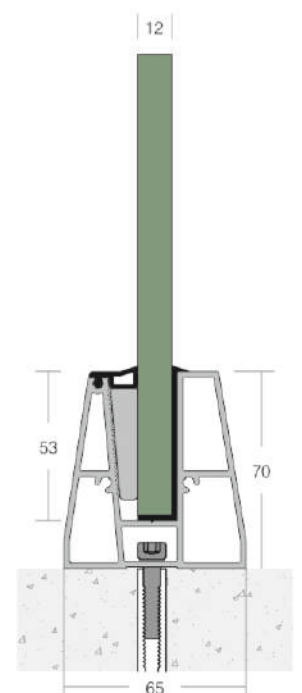
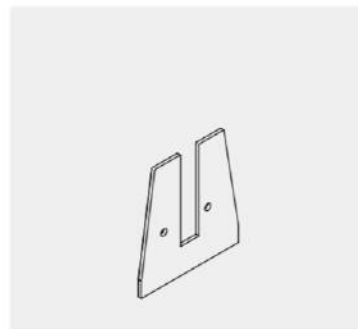



DVH-02

SLOPE Continue System

Finishes

Wooden | Anodized | PVDF | Powder Coating

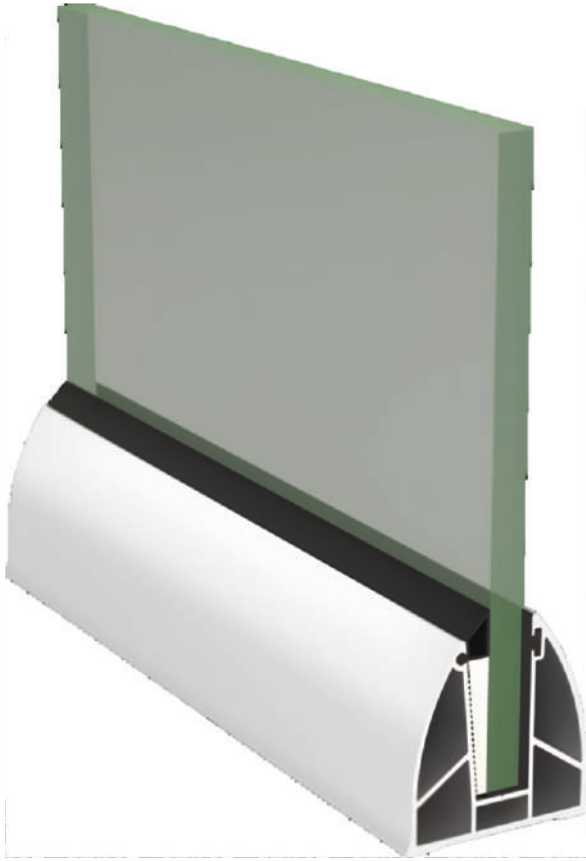

Essential Features

Architectural Aesthetics by Oval and Angled Rail Profile.

Aesthetic Design with Maximum View.

Easy Installation Saves Workmanship and Time.

It is Ideal for Indoor and Outdoor.

- The sturdy construction and high-quality materials make this railing the perfect investment for any homeowner.
- The features of this system are not limited, corrosion resistance and light weight they also extends to easy to maintain attractive design.
- This profile comes in 16 ft length.
- Profile is compatible for upto 3 ft height of glass.



DVH-02

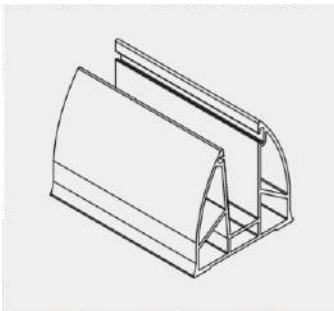

DVH-02 EC

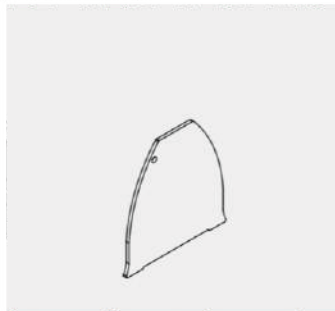

DVH-02 EC SLOTTED

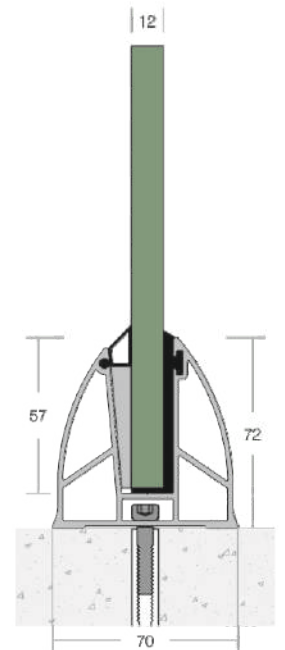
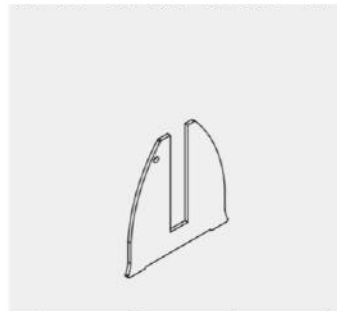



DVH-03

LARGE Continue System

Finishes

Wooden | Anodized | PVDF | Powder Coating



Essential Features

Easy Glass Installation.

Can be used in Highrise Buildings.

Aluminium cladding with a Stainless Steel Effect.

For Applications in the Public Area.

- A sturdy railing that can be used to protect people from the side of a staircase or a balcony.
- Aluminum railing will not corrode, making it the perfect material for a railing that will last.
- This profile comes in 12 ft length.
- Profile is compatible for upto 4 ft height of glass and can also be used frameless.



DVH-03

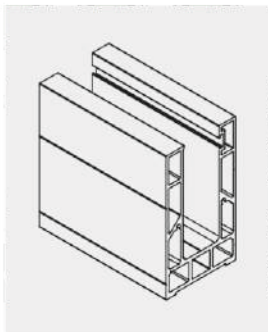

DVH-03 EC

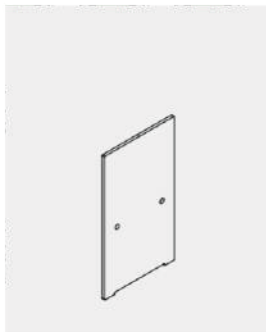

DVH-03 EC SLOTTED

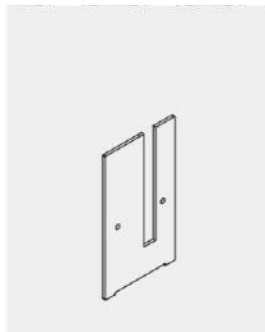

DVH-03 SQ

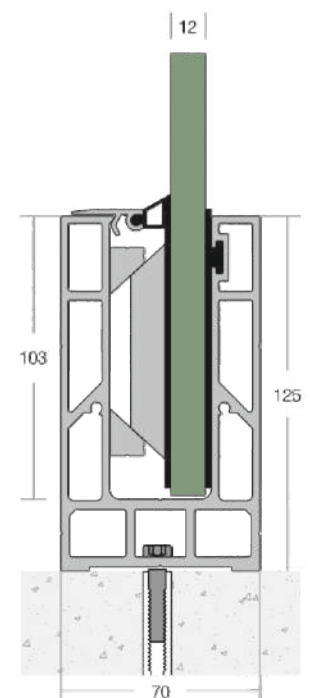



DVH-04

HEAVY Continue System

Finishes
Wooden | Anodized | PVDF | Powder Coating



Essential Features

Slim Line, Elegant Design and Low Maintenance.

Can be used in Interior and Exterior.

Suitable for Concrete Floor and Steel Construction.

For Applications in the Public Area.

- | This railing is made of sturdy aluminium and will be a beautiful addition to any porch. The design is sleek and simple.
- | This product is perfect for any commercial or residential application and will not rust, rot or corrode.
- | This profile comes in 12 ft length.
- | Profile is compatible for upto 4 ft height of glass and can also be used frameless.



DVH-04

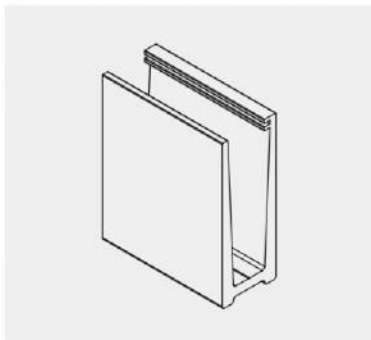

DVH-04 EC

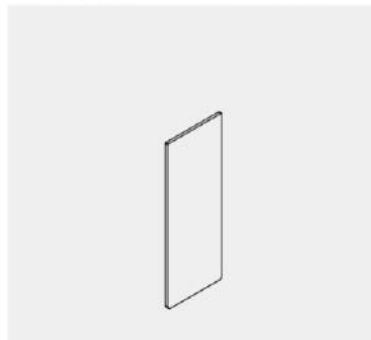

DVH-0 EC SLOTTED

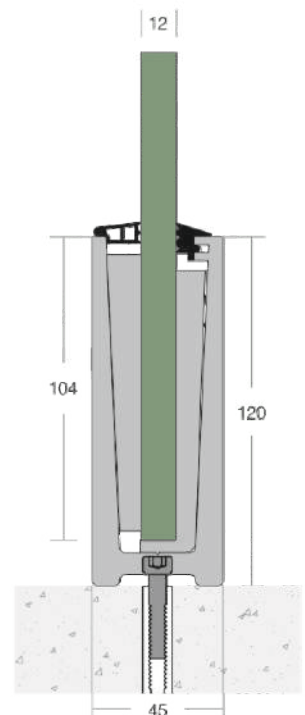
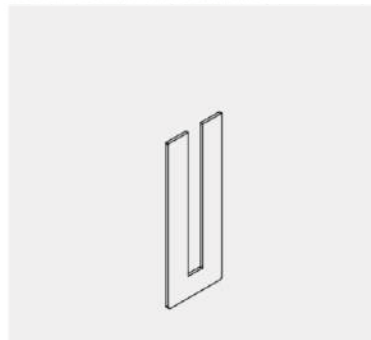



DVH-05

MEDIUM Concealed Profile System / Top Mount System

Finishes

Wooden | Anodized | PVDF | Powder Coating

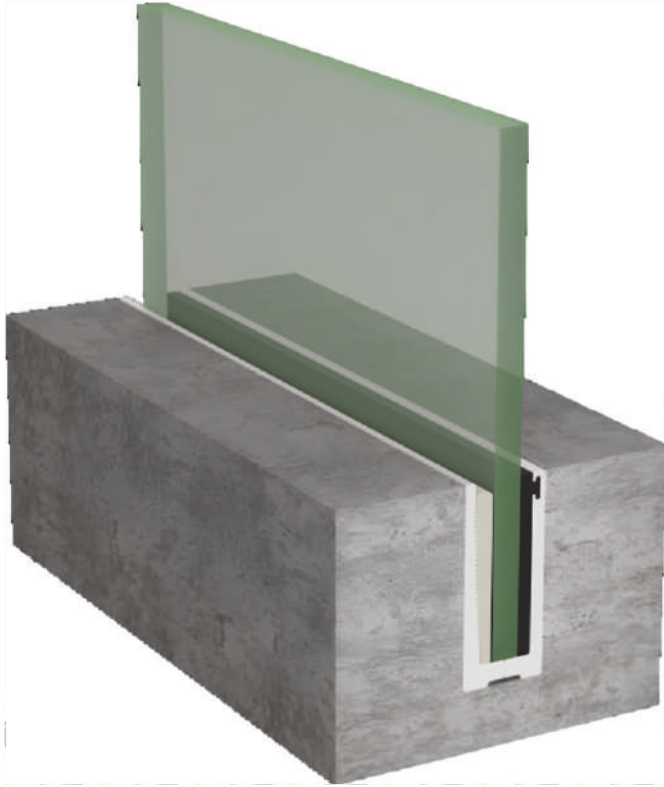

Essential Features

Top, Ceiling and Conceal Mounting.

High Structural Strength Provides Maximum Security.

Slim Line, Elegant Design and Low Maintenance.

Optimally Suited for Concrete Upstand.

- | This railing is built to be both elegant and functional, and is easy to install.
- | The best part is that this railing is maintenance-free and will never rust.
- | This profile comes in 16 ft length.
- | Profile is compatible for upto 3.5 ft height of glass and can also be used frameless.



DVH-05

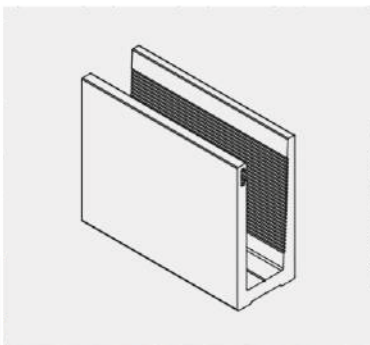

DVH-05 EC

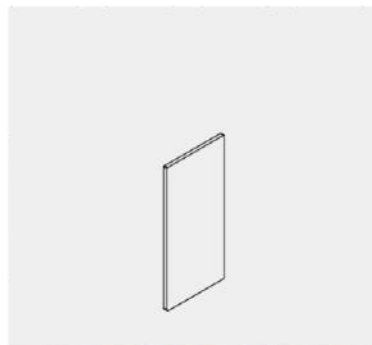

DVH-05 EC SLOTTED

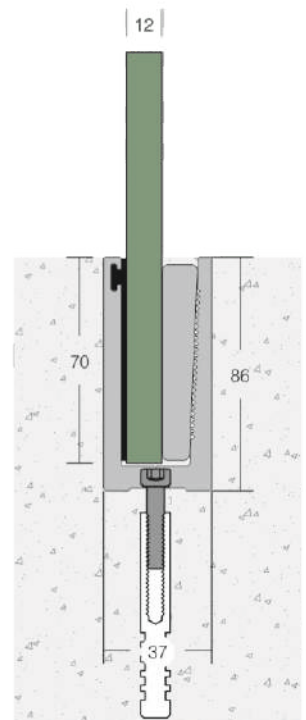
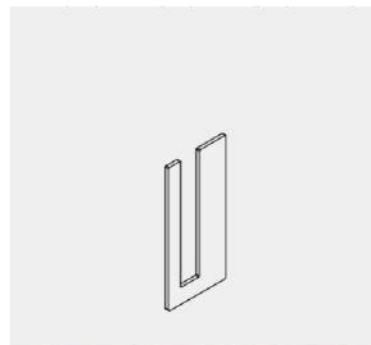



DVH-06

SMALL Continue System

Finishes

Wooden | Anodized | PVDF | Powder Coating



Essential Features

Space Saving and Minimalist Design.

Economical with Good Aesthetic Design.

Specially for Residence, Hotels and Public Area.

It is Ideal for Indoor and Outdoor.

- The light and slim aluminium railing is a perfect solution for areas where traditional railing can't be installed.
- Aluminum railing will not corrode, making it the perfect material for a railing that will last.
- This profile comes in 16 ft length.
- Profile is compatible for upto 3 ft height of glass.



DVH-06

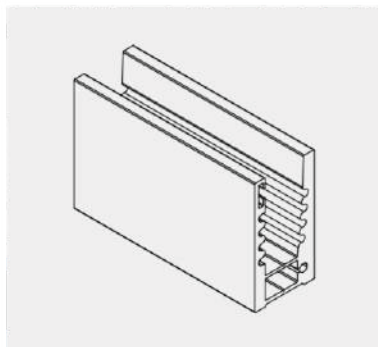

DVH-06 EC

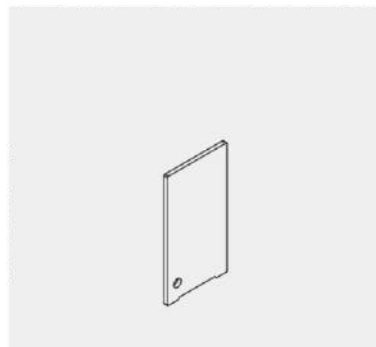

DVH-06 EC SLOTTED

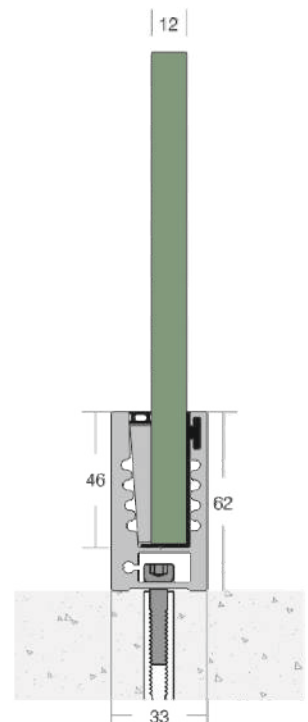
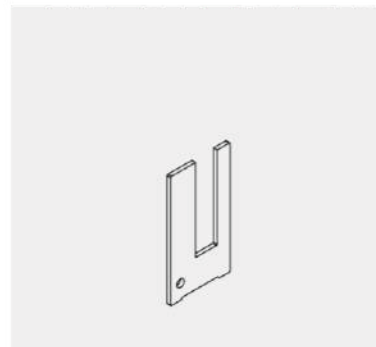



DVH-07

STEP BOTTOM Bracket-Cover System

Finishes

Wooden | Anodized | PVDF | Powder Coating



Essential Features

Slope Design for Perfect Aesthetic View.

Can be used in Interior and Exterior.

Suitable for Concrete Floor and Steel Construction.

For Applications in the Public Area.

- The aluminium cover railing is an attractive alternative to the standard metal railing.
- This product is perfect for any commercial or residential application and will not rust, rot, or corrode.
- This system comes with bracket covered with continue profile with maximum length of 16ft.
- Profile is compatible for upto 3 ft height of glass...
- Best used bracket at every 2.5 ft of distance.



DVH-07A

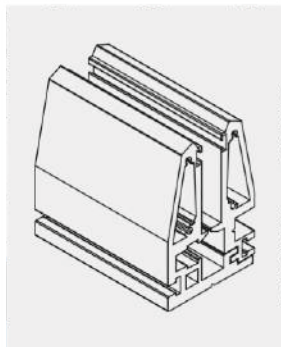

DVH-01A CV

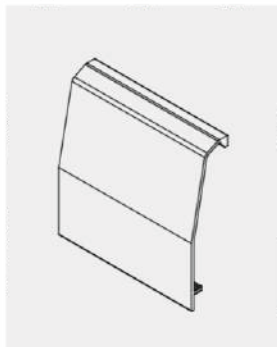

DVH-01A EC

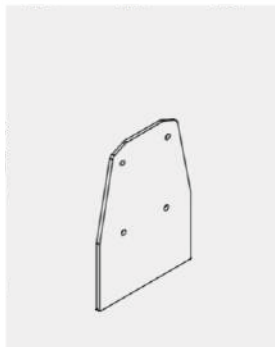

DVH-01A EC SLOTTED

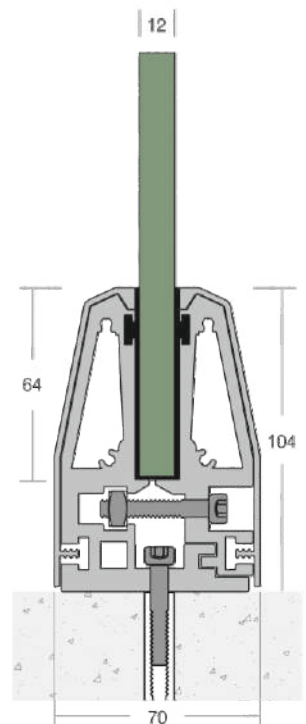
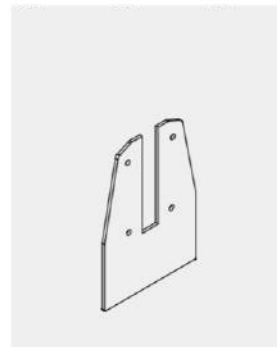



DVH-08

STEP BOTTOM Bracket-Cover System

Finishes

Wooden | Anodized | PVDF | Powder Coating



Essential Features

Premium Design in the Segment.

Can be used in Interior and Exterior.

Suitable for Concrete Floor and Steel Construction.

For Applications in the Public Area.

- A square cover aluminium railing is an attractive and sturdy railing for any deck or patio.
- The best part is that this railing is maintenance-free and will never rust.
- This system comes with bracket covered with continue profile with maximum length of 16 ft.
- Profile is compatible for upto 3 ft height of glass...
- Best used bracket at every 2.5 ft of distance.



DVH-08B

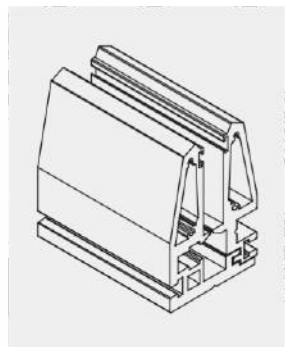

DVH-08B CV

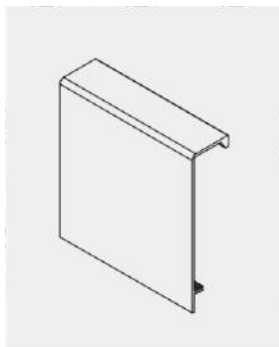

DVH-08B EC

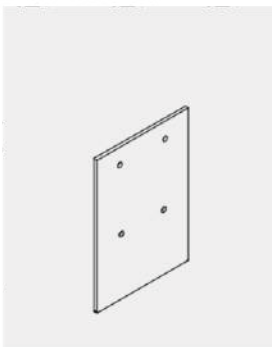

DVH-08B EC SLOTTED

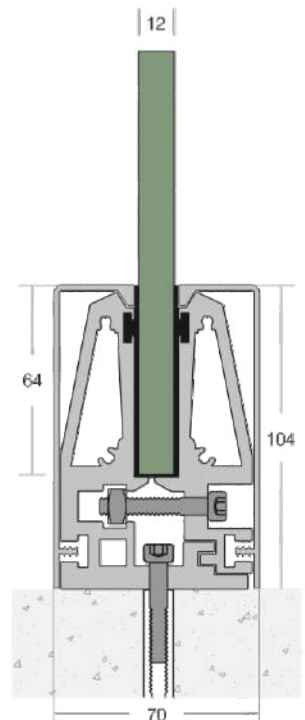
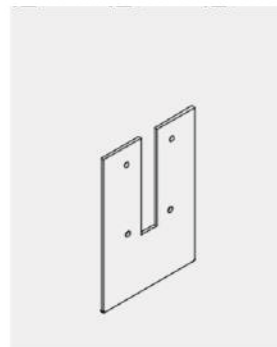



DVH-09

OVAL SHAPED Bracket-Cover System

Finishes

Wooden | Anodized | PVDF | Powder Coating



Essential Features

High Structural Strength
Provides Maximum Safety.

Strongest Architectural by Oval
and Angled Cover.

Comfort with Assembly and
Installation.

With the Design it Saves Space.

- ▮ Slope aluminium railing is also easy to install and does not require a professional to install.
- ▮ This product is perfect for any commercial or residential application and will not rust, rot, or corrode.
- ▮ This system comes with bracket covered with continue profile with maximum length of 16ft.
- ▮ Profile is compatible for upto 4 ft height of glass...
- ▮ Best used bracket at every 2.5 ft of distance.



DVH-09

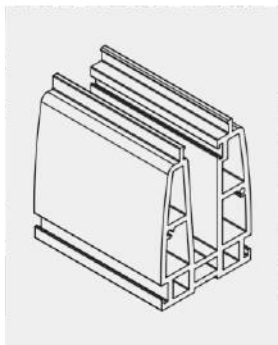

DVH-09 CV

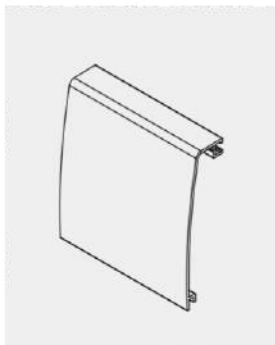

DVH-09 EC

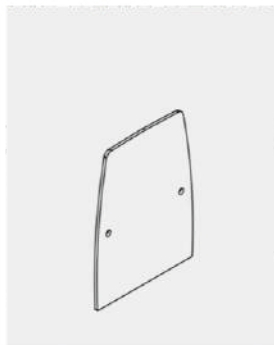

DVH-09 EC SLOTTED

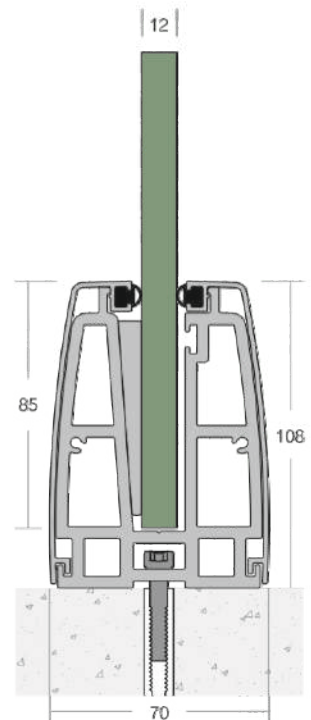
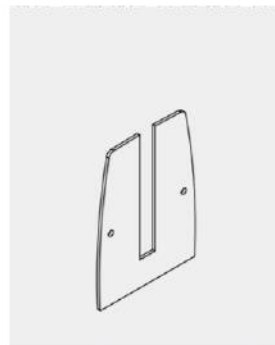



DVH-10

HEAVY BOTTOM Bracket-Cover System

Finishes

Wooden | Anodized | PVDF | Powder Coating

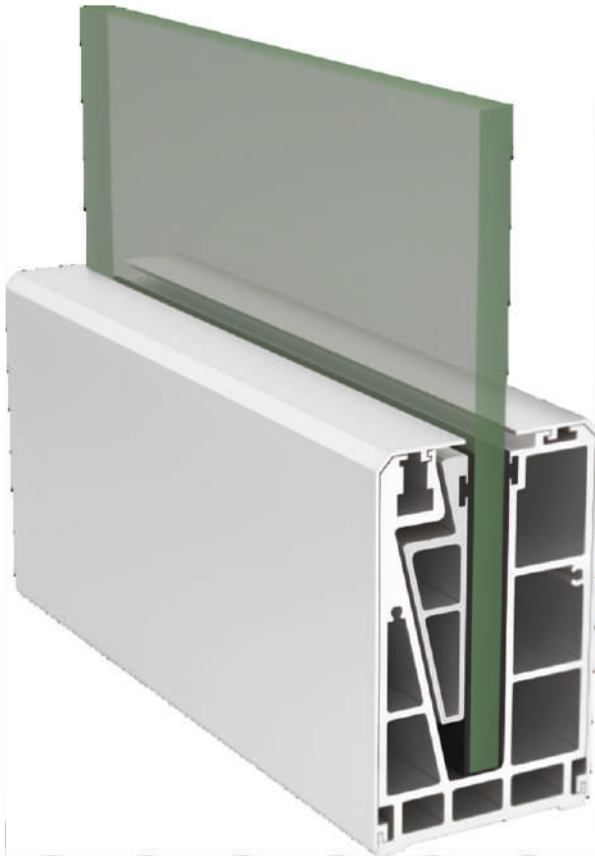

Essential Features

Suitable for Frameless System.

High Structural Strength
Provides Maximum Security.

No Need a System for Water
Drainage.

Specially For Residence, Hotels,
High Rise Buildings.

- | This is the perfect solution for any type of railing, including deck railings, porch railings.
- | The features of this system are not limited, corrosion resistance also extends to east to maintain attractive design.
- | This system comes with bracket covered with continue profile with maximum length of 16 ft.
- | profile is compatible for upto 4 ft height of glass. Even used without handrail frameless.
- | Best used bracket at every 2.5 ft of distance.



DVH-10

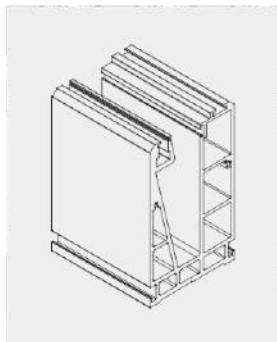

DVH-10 CV

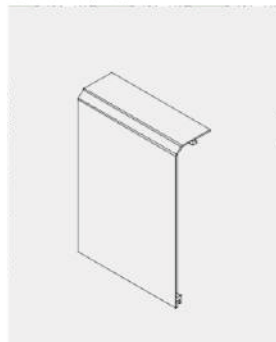

DVH-10 EC

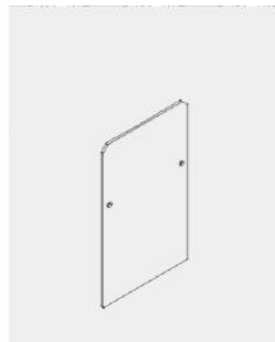

DVH-10 EC SLOTTED

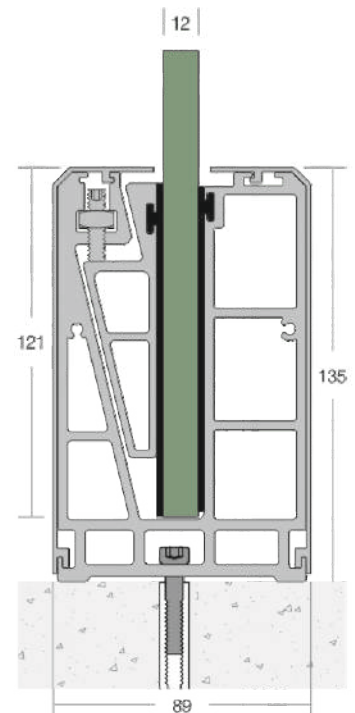
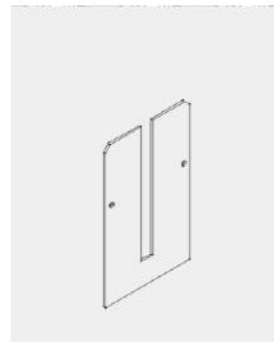



DVH-11

SIDE MOUNTED Bracket-Cover System

Finishes

Wooden | Anodized | PVDF | Powder Coating



Essential Features

Clear Views from Areas Enclosed by Floor.

Slim Line, Elegant Design and Low Maintenance.

Space Saving Minimalist Design.

High Resistance to Deformation Provides High Strength to the System.

- | This profile designed in a way that completely looks frameless.
- | The best part is that this railing is maintenance-free and will never rust.
- | This system comes with bracket covered with continue profile with maximum length of 16ft.
- | Profile is compatible for upto 3 ft height of glass.
- | Best used bracket at every 2.5 ft of distance.



DVH-11

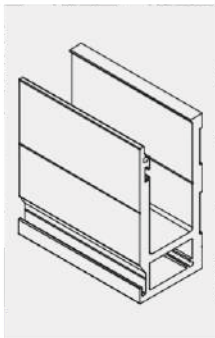

DVH-11 CV

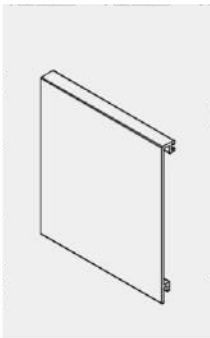

DVH-11 EC

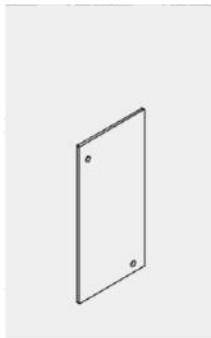

DVH-11 EC SLOTTED

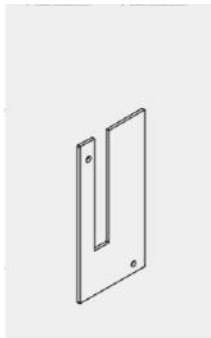

DVH-11 SQ

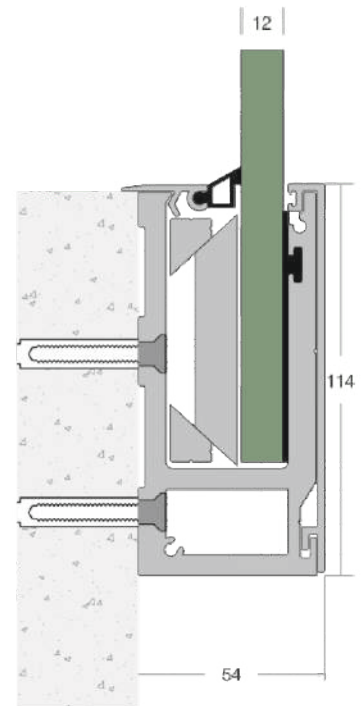



DVH-12

LARGE BOTTOM Bracket System

Finishes

Wooden | Anodized | PVDF | Powder Coating



Essential Features

Suitable for Staircase and Balcony.

Easy Installation, Easy Maintenance.

Economical and Compatible.

Perfect Aesthetic View.

- This is often a concern for people who live in homes that have balconies, stairs, or outdoor staircases.
- Bracket lengths are available in 70 mm & 140 mm.
- Bracket is compatible for upto 1100 mm height of glass.
- Brackets can be used at every 2.5 ft of distance.
- Designed for saving workmanship and time.



DVH-12

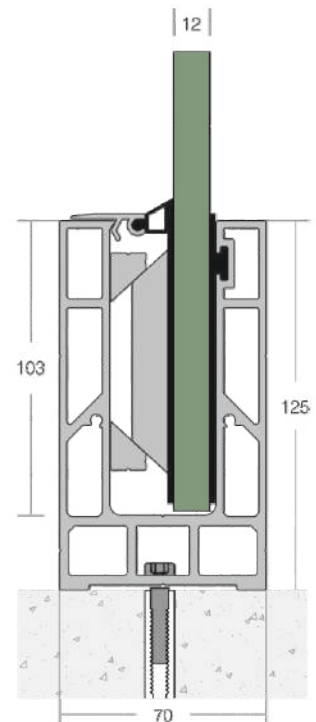
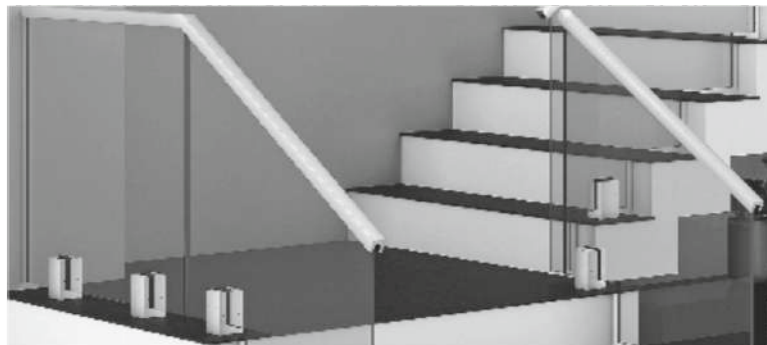
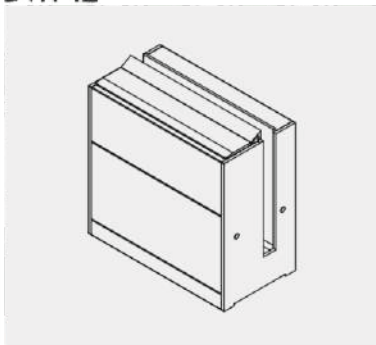



DVH-13

"T" TYPE Bracket System

Finishes

Wooden | Anodized | PVDF | Powder Coating



Essential Features

Economical and Compatible.

Easy Installation Saves Workmanship and Time.

Space Saving and Minimalist Design.

Mostly Used in Commercial Buildings.

- With its clean lines and minimalist design, the ALUMINIUM GLASS T BRACKET is the perfect way to complete your decor.
- The bracket length available in 70 mm.
- Bracket is compatible for upto 1000 mm height of glass.
- Brackets can be used at every 2.5 ft of distance.
- Designed for saving workmanship and time.



DVH-13

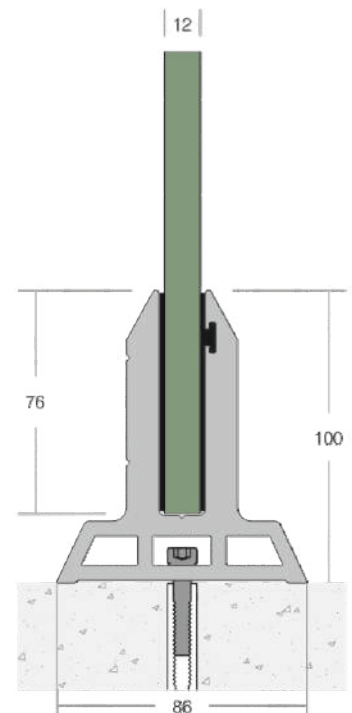
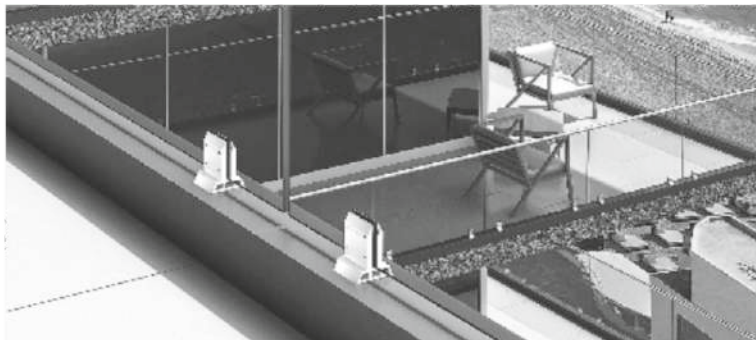
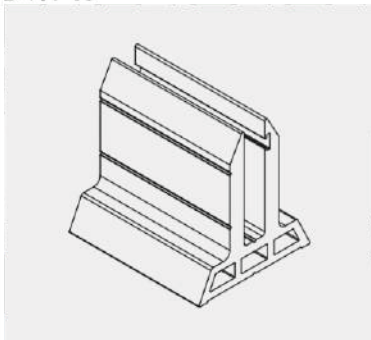



DVH-14

STEP BOTTOM Bracket System

Finishes

Wooden | Anodized | PVDF | Powder Coating



Essential Features

Suitable for Staircase and Balcony.

Easy Installation, Easy Maintenance.

Economical and Compatible.

Perfect Aesthetic View.

- A slope aluminum glass bracket is a sleek and modern mounting solution for attaching a glass panel to a surface.
- Bracket lengths are available in 70 mm & 140 mm.
- Bracket is compatible for upto 1000 mm height of glass.
- Brackets can be used at every 2.5 ft of distance.
- Designed for saving workmanship and time.



DVH-14

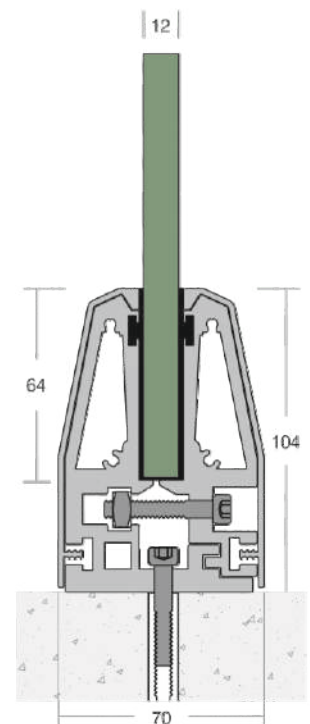
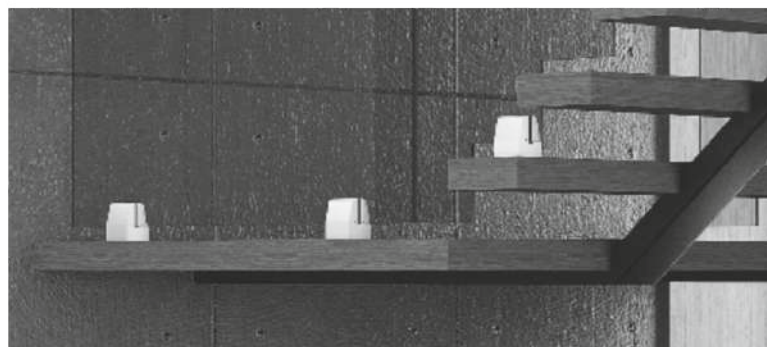
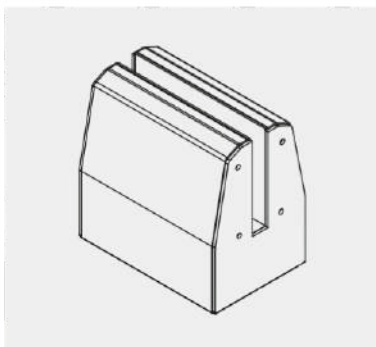



DVH-15

DIAMOND Bracket System

Finishes
Wooden | Anodized | PVDF | Powder Coating



Essential Features

Light Commercial and Residential Use.

Economical Design.

Widely Used for Stairs and Balconies.

- This bracket is crafted from high-quality aluminum, & the design making it lightweight and strong.
- Bracket lengths are available in 70 mm & 140 mm.
- Bracket is compatible for upto 900 mm height of glass.
- Brackets can be used at every 2.5 ft of distance.
- Designed for saving workmanship and time.



DVH-15

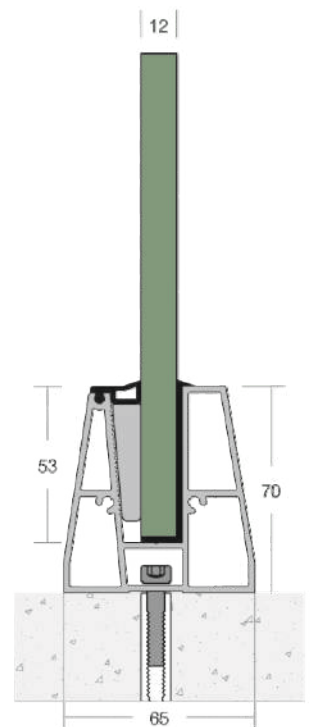
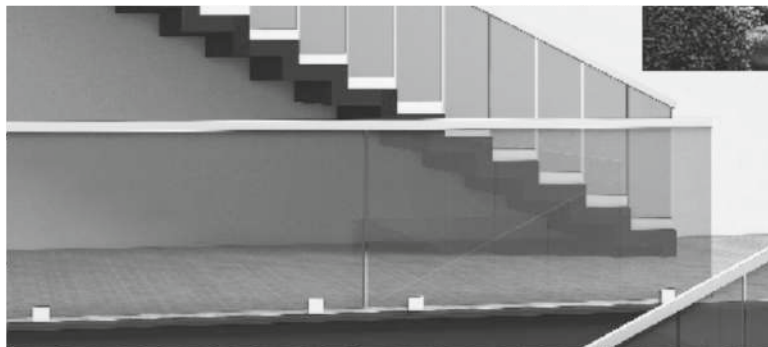
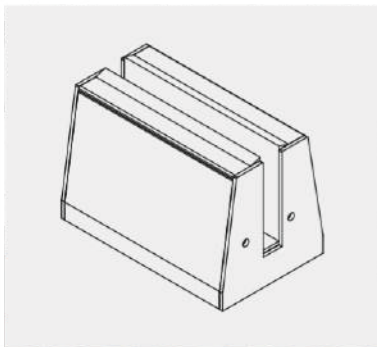



DVH-16

FERRY Bracket System

Finishes
Wooden | Anodized | PVDF | Powder Coating



Essential Features

Light Commercial and Residential Use.

Economical Design.

Widely Used for Stairs and Balconies.

- Our Ferry Glass Aluminum Bracket is the perfect solution for mounting glass on your porch or balcony.
- Bracket lengths are available in 70 mm & 140 mm.
- Bracket is compatible for upto 900 mm height of glass.
- Brackets can be used at every 2.5 ft of distance.
- Designed for saving workmanship and time.



DVH-16

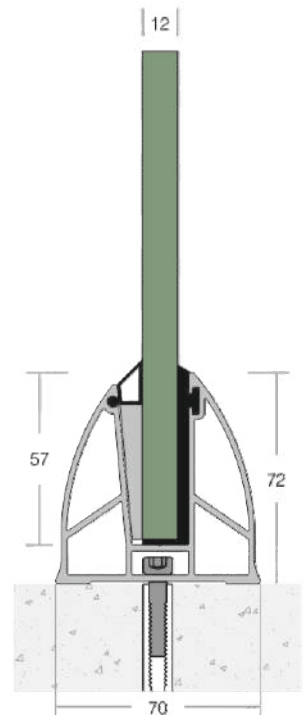
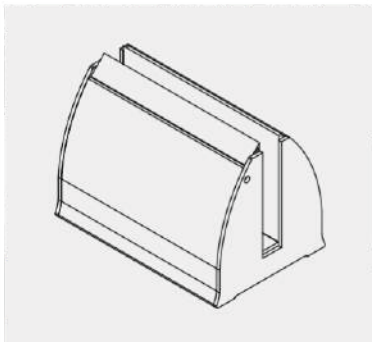



DVH-17

"L" TYPE Bracket System

Finishes

Wooden | Anodized | PVDF | Powder Coating



Essential Features

Economical and Compatible.

Easy Installation Saves Workmanship and Time.

Space Saving and Minimalist Design.

Mostly used in Commercial Buildings.

- The "L" shaped bottom glass bracket is a versatile and stylish bracket that can be used in many different ways.
- The bracket length available in 70 mm.
- Bracket is compatible for upto 1000 mm height of glass.
- Brackets can be used at every 2.5 ft of distance.
- Designed for saving workmanship and time.



DVH-17

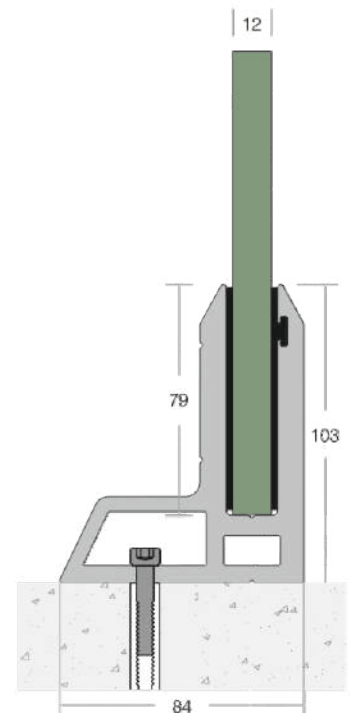
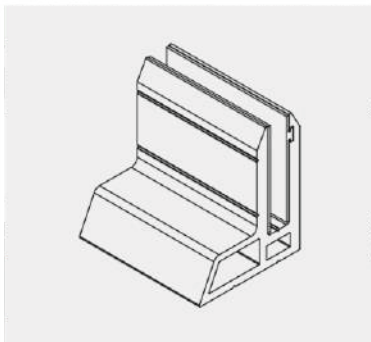



DVH-18

STEP Bracket System

Finishes

Wooden | Anodized | PVDF | Powder Coating



Essential Features

Suitable for Staircase and Balcony.

Easy Installation, Easy Maintenance.

Economical and Compatible.

Perfect Aesthetic View.

- The Square Aluminium Glass Bracket is a very versatile product that can be used in balcony & stairs seamlessly.
- Bracket lengths are available in 70mm & 140mm.
- Bracket is compatible for upto 1000 mm height of glass.
- Brackets can be used at every 2.5 ft of distance.
- Designed for saving workmanship and time.



DVH-18

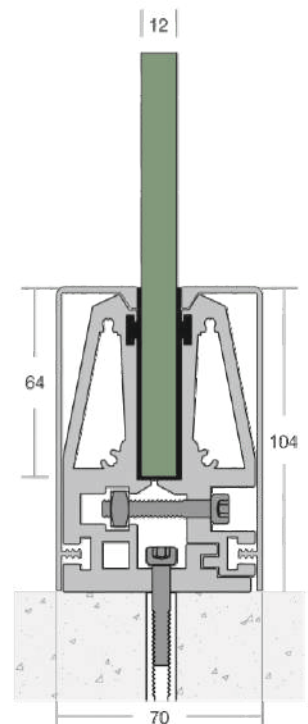
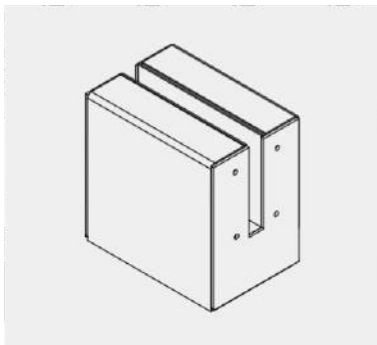



DVH-19

OVAL Bracket System

Finishes

Wooden | Anodized | PVDF | Powder Coating



Essential Features

Suitable for Staircase and Balcony.

Easy Installation, Easy Maintenance.

Economical and Compatible.

Perfect Aesthetic View.

- The oval aluminium glass bracket is perfect for any modern home. The sleek and elegant design of the bracket makes it perfect for both commercial and residential use.
- Bracket lengths are available in 70 mm & 140 mm.
- Bracket is compatible for upto 1200 mm height of glass.
- Brackets can be used at every 3 ft of distance.
- Designed for saving workmanship and time.



DVH-19

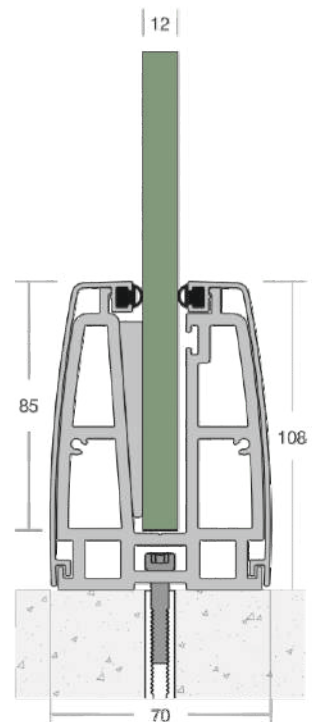
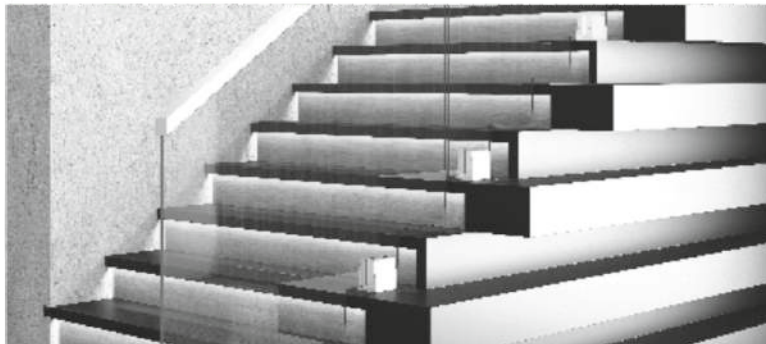
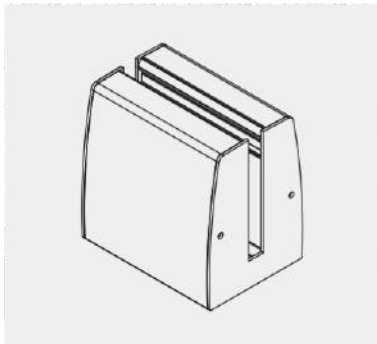



DVH-20

HEAVY Bracket System

Finishes

Wooden | Anodized | PVDF | Powder Coating



Essential Features

Suitable for Staircase and Balcony.

Easy Installation, Easy Maintenance.

Economical and Compatible.

Perfect Aesthetic View.

- Easy glass up ultra - slender and base bottom bracket system, allow you to create balcony railing with endless view.
- Bracket lengths are available in 70 mm & 140 mm.
- Bracket is compatible for upto 1300 mm height of glass.
- Brackets can be used at every 3 ft of distance.
- Designed for saving workmanship and time.



DVH-20

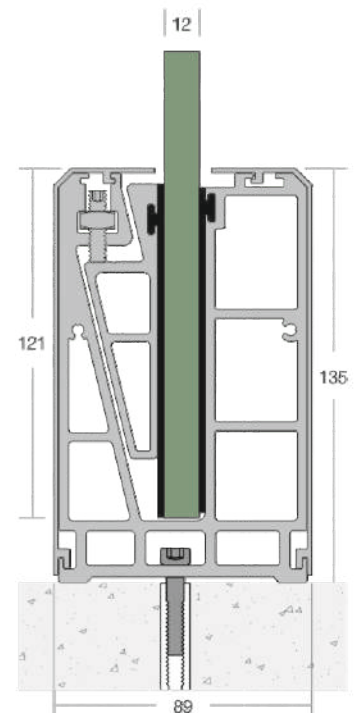
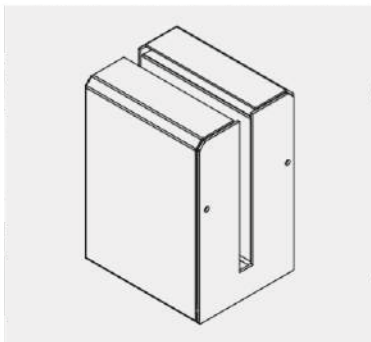

DVH-21 (50 mm) ROUND



DVH-22 (50x50mm) SQUARE



DVH-23 (65x45mm) RECTANGLE



DVH-24 (55x55 mm) 'U' TYPE



DVH-25 (80x35mm) INCLINE



DVH-26 (40x40mm) SQUARE

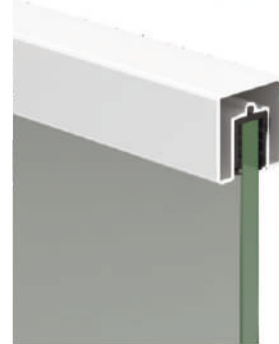

DVH-27 (25x25mm) SLIM LINE



DVH-28 (65x40mm) CLUB

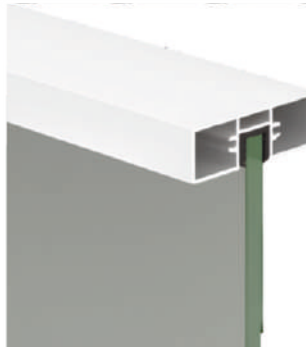

DVH-29 (70x35mm) LED



DVH-30 (50 mm) ROUND



DVH-31 (50 mm) ROUND



DVH-32 (50 mm) ROUND



HANDRAIL Accessories

Finishes

Wooden | Anodized | PVDF | Powder Coating

BALUSTRADE System

Essential Features

- | Suitable for Staircase and Balcony. | Maintenance Free.
- | Corrosion Resistance. | SS 304 / 316 Grade | Top / Side Mount

DVH-33



Patta Type (12 mm x 50 mm)

DVH-33

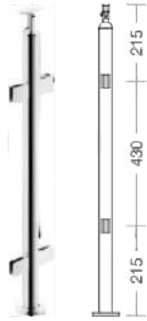

Pipe Type (50ø / 40ø mm)

DVH-34



Pipe Type (40 mm x 40 mm)

DVH-35

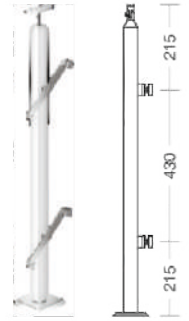

Pipe Type (40 mm x 40 mm)

DVH-36

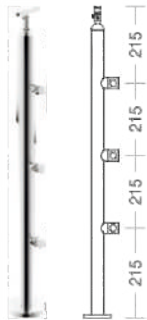

Pipe Type (50ø / 40ø mm)

DVH-37



Pipe Type (50ø / 40ø mm)

DVH-38

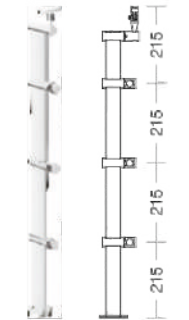

Patta Type (12 mm x 50 mm)

SIDE MOUNT

SS 304 / 316
Grade

Flat Patta
12 x 50 mm



Pipe
40 x 40 mm



Round
50ø / 40ø mm



SPIGOT

SS 304 / 316
Grade

DVH-39

10 x 40 mm



Height : 8" / 9" / 10"

DVH-40



Height : 6"

DVH-41

10 x 40 mm



Height : 8" / 9" / 10" / 12"

Industries Application

AIRPORTS



Residential Projects



SHOPPING MALL



METRO STATION



HOSPITALS



OFFICE BUILDING





Our Vision

100%

Customer Oriented

DA VINCI ARCHITECTURAL HARDWARE is a 100% customer-oriented organization and our goal is to provide our customers with the highest-quality, lowest-cost railing system available anywhere in the world. Our team members are highly skilled and take pride in creating solutions that best fit the exacting needs of our customers.



Integrity

Our integrity must never be compromised. We stand behind our products and our word. We deliver a quality product at a fair price to every customer. We honor the commitments we make of achieving full customer satisfaction.



Partnership With People

People are the key to our success. We are dedicated to the education, development and involvement of all UNITED Metal team members. We strive to meet and exceed the needs of our customers.



Customer Driven

We believe we exist because of satisfied customers and we are committed to provide full customer satisfaction over the long term. We will seek, fully understand, and strive to meet and exceed the needs of our customers.



Our mission:

Our mission is to bring beauty and safety to their living spaces by providing Railing solutions that exceed their expectations.



Honesty

We treat our colleagues, our suppliers with honesty, trust and respect. We work together as an integrated, cross-functional team with a common goal.



Our Values

Quality First - Quality for all our customers, internal and external, comes first. We Design and build 100% conformance globally quality standards.



Continuous Improvement

We treat our colleagues, our suppliers with honesty, trust and respect. We work together as an integrated, cross-functional team with a common goal.



Our Branches

- Delhi
- Ahmedabad
- Rajkot
- Mumbai
- Hyderabad
- Coimbatore

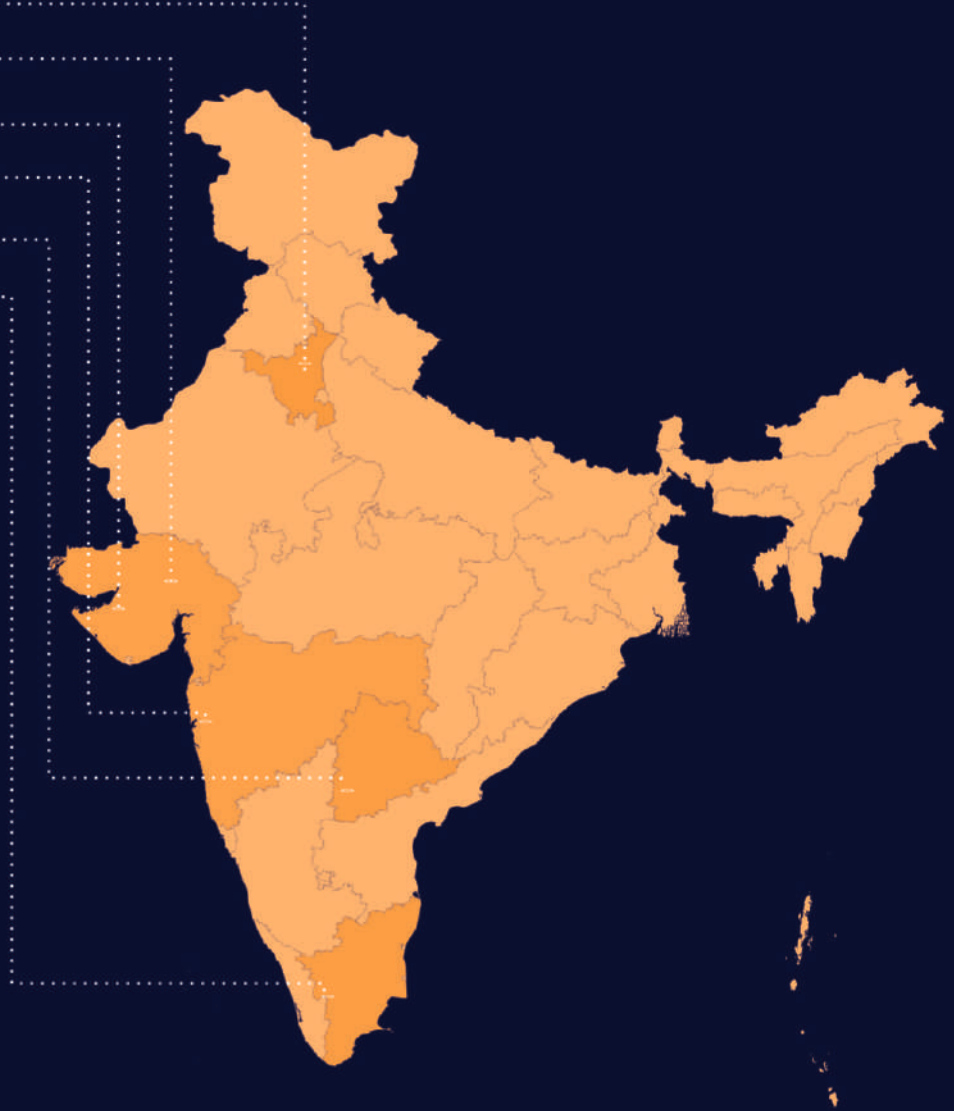

📍 Our Head Office And Factory :
62, Union Estate, Nr. Gujarat Bottling
Rakhial, Ahmedabad - 380023

☎ +91 63546 71397

✉ info@davinci.co.in
sales.davincisteel@gmail.com

📍 Regional Office :
No. 15B, Mogappair Road,
Mannurpet Padi, Chennai - 600050

☎ +91 63803 42510 / 72000 71924

✉ info@davinci.co.in
sales.davincisteel@gmail.com